

Folding Instruction - Boxes with Slip Lid

1. Unfolded side with 3 grooves and flaps

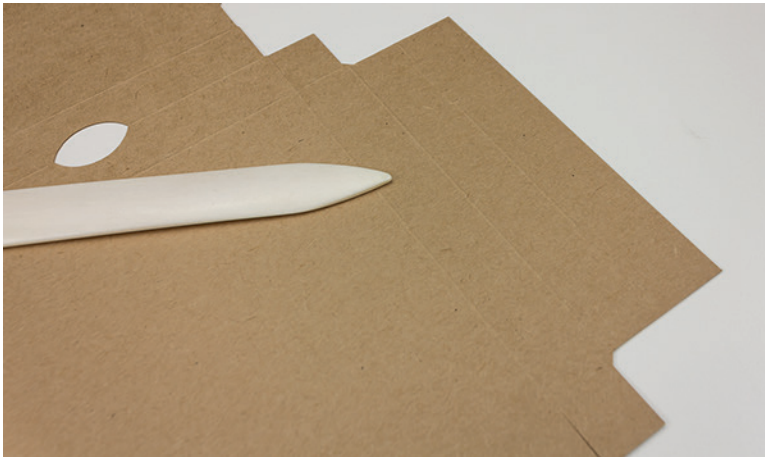

The smooth surface of the lid lies on the table.
This will be the outer face of the box.

The surface you see, isn't visible anymore after folding.

2. At first fold the flap inward at the inner groove. Fold back this line.

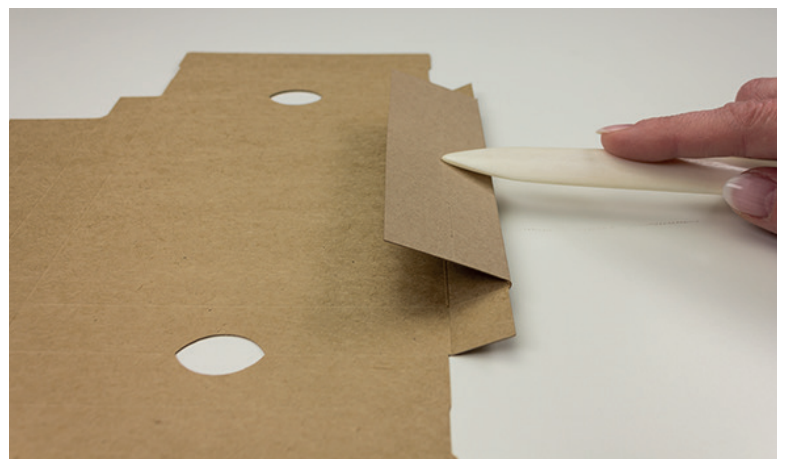
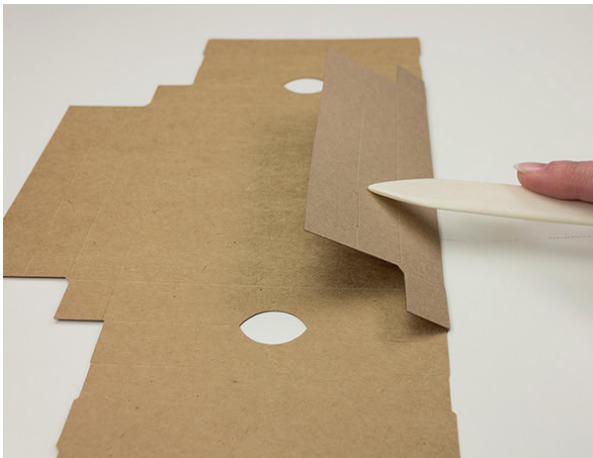

3. Fold the flap at the middle groove inward likewise.

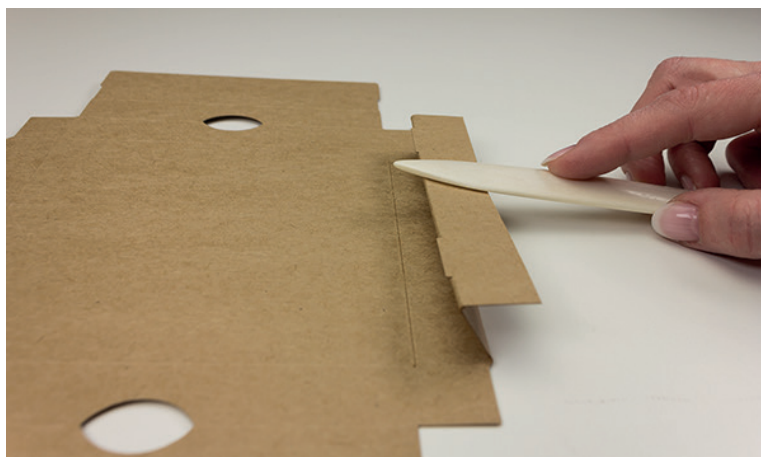

4. On the third outer groove fold the flap in the opposite direction.

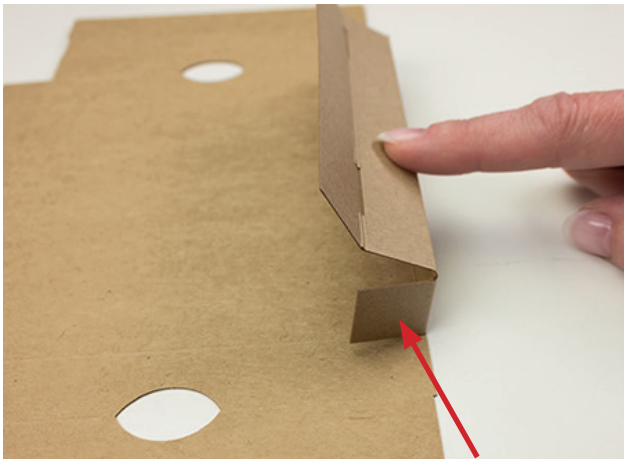

5. Fold the small tongues inward.

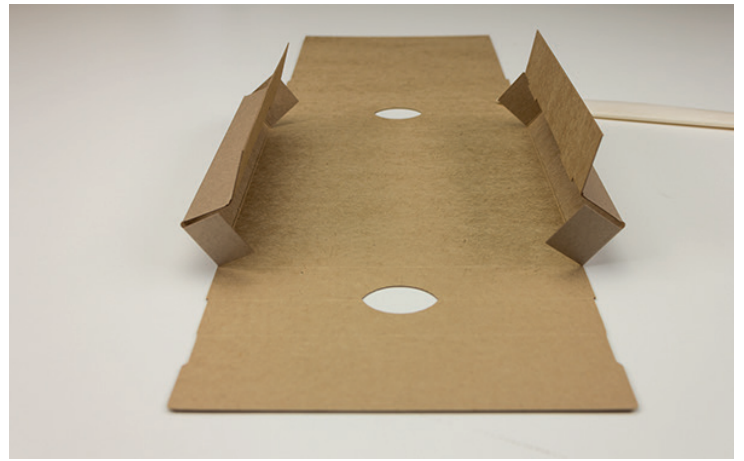

6. Both sides are pre-folded.
The tongues are folded inward.



7. You see the pre-folded front side with the subsequent grip hole.



8. All sides are pre-folded.
At the left you see the front with grip hole. At right you see the back with the inside of lid, folded outwards.
In the foreground and background are shown in each case the two side walls with set up tongues.

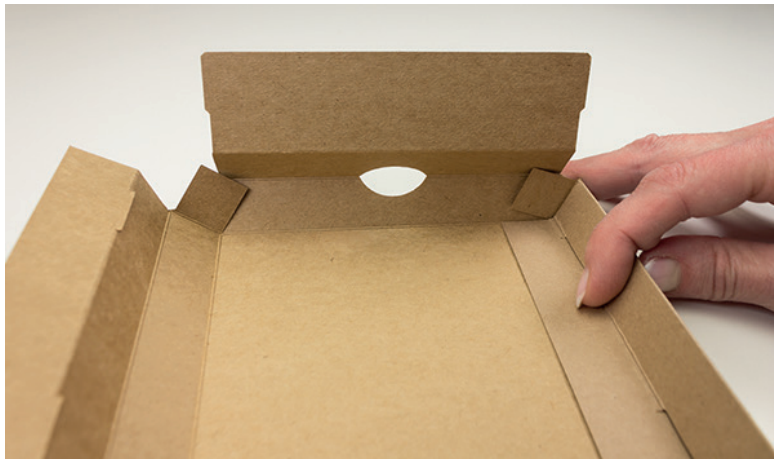

9. Set on the side-walls. Fold the flaps inward, then fold the front and the back over the flaps.



10. The side-walls are set on. The front is also set on and folded over the tongues.

In the front you see the open back, which still need to be erected and be folded over the both tongues of the side-walls.



11. The rear with grip hole get erected and folded over the tongues of the side-walls.



12. Finally, the inner cover is laid flat inside.
All inner edges are pressed on strongly.



13. Lid is ready now.
Additionally you can glue the items before assembling.



14. Lid and box are ready.
Fold the box in the same way like the lid.
Erect the side-walls, fold the front and back over the tongues, fold the inner base inwards and press it firmly on the inner edges.